

Castle Street, Grimsby, DN32 7LB

Offers Around £80,000

Council Tax Band: A



Welcome to Castle Street, Grimsby - a location that could be the perfect setting for your new home! This delightful semi-detached house, boasts a generous 1,094 sq ft (approx.) of living space, offering ample room for comfortable living.

As you step inside, you are greeted by two spacious reception rooms, ideal for entertaining guests or simply relaxing with your loved ones. The property features three cosy bedrooms, providing a peaceful retreat for the whole family.

One of the highlights of this property is the newly renovated kitchen. Additionally, the new bathroom adds a touch of luxury to this characterful home.

Convenience is key with the inclusion of a utility room, making household chores a breeze. The property's layout is thoughtfully designed to cater to your everyday needs, ensuring a seamless living experience.

Currently rented at £660 per month, with good working tenant paying rent on time, full statements are available upon request.

Don't miss out on the opportunity to make this house your home. With its historical charm, ample living space, and modern updates, this property on Castle Street is just waiting for you to add your personal touch and make it truly yours.



Mayfair Estate Agents Powered by Open House

Ground Floor

Approx. 46.4 sq. metres (499.9 sq. feet)

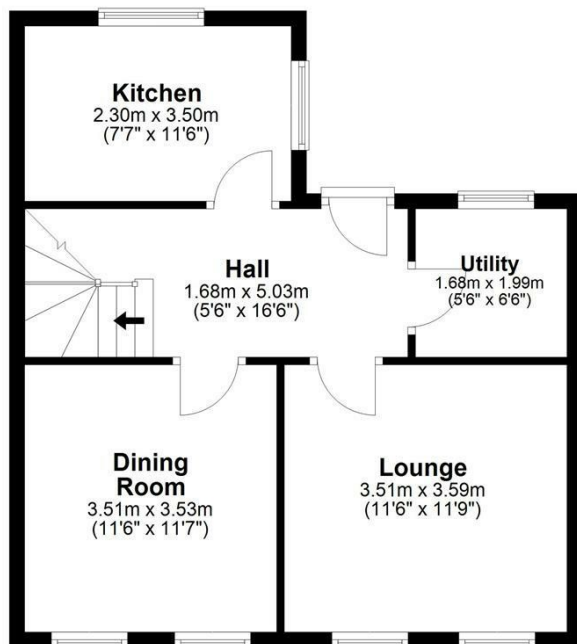

First Floor

Approx. 46.4 sq. metres (499.9 sq. feet)

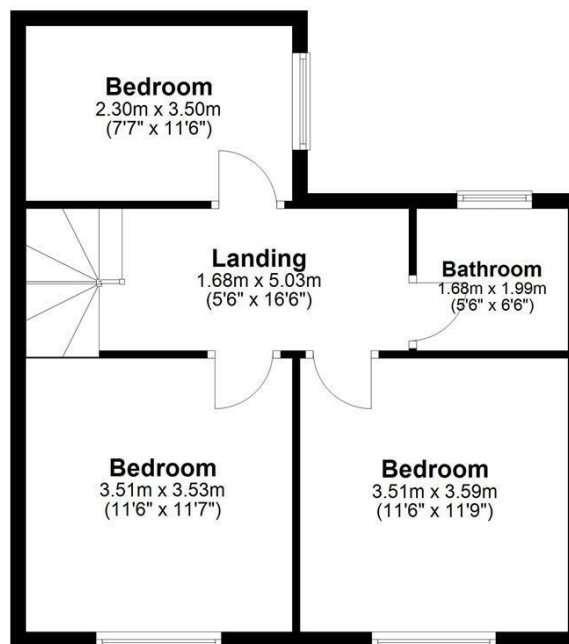

Total area: approx. 92.9 sq. metres (999.8 sq. feet)



Energy Efficiency Rating		
	Current	Potential
Very energy efficient - lower running costs		
(92 plus) A		
(81-91) B		86
(69-80) C		
(55-68) D	62	
(39-54) E		
(21-38) F		
(1-20) G		
Not energy efficient - higher running costs		
England & Wales	EU Directive 2002/91/EC	